



TIMKEN® SELF-ALIGNING BALL BEARINGS

ENGINEERED FOR UP TO 3° MISALIGNMENT

Timken self-aligning ball bearings help protect equipment when shafts deflect or mounts aren't perfectly square. They handle up to 3° misalignment (sealed versions 1.5°) - without sacrificing performance or life.

COOLER-RUNNING POLYMER CAGES

A high-performance polymer cage promotes lubricant flow and low friction. Bearings run cooler at speed for longer grease life and reliable operation.

WIDE PRODUCT OFFERING

Configure to your build: open or sealed designs, cylindrical or tapered bores, and normal (C0) or C3 clearance - backed by Timken engineering and global support.

EASY INTERCHANGE

Our self-aligning ball bearings follow ISO standards and are dimensionally interchangeable with competitor metric products. They can be mounted inside Timken SNT or equivalent housings.

BUILT FOR CRITICAL APPLICATIONS

Self-aligning ball bearings are a good fit for applications requiring high speed and varying load conditions:

- Light-load conveyors for packaging and food processing
- Fans and blowers
- Equipment for agricultural, textile, pulp & paper, chemical and wood processing industries

Features & Benefits

- Up to 3° misalignment, consistent performance
- Polymer cage reduces heat at speed
- Sealed designs boost uptime
- Normal or C3 clearance ensures fit
- Pre-greased sealed versions extend service
- Tapered bore designs for mounting with adapter sleeves on plain shafts



PRODUCT RANGE

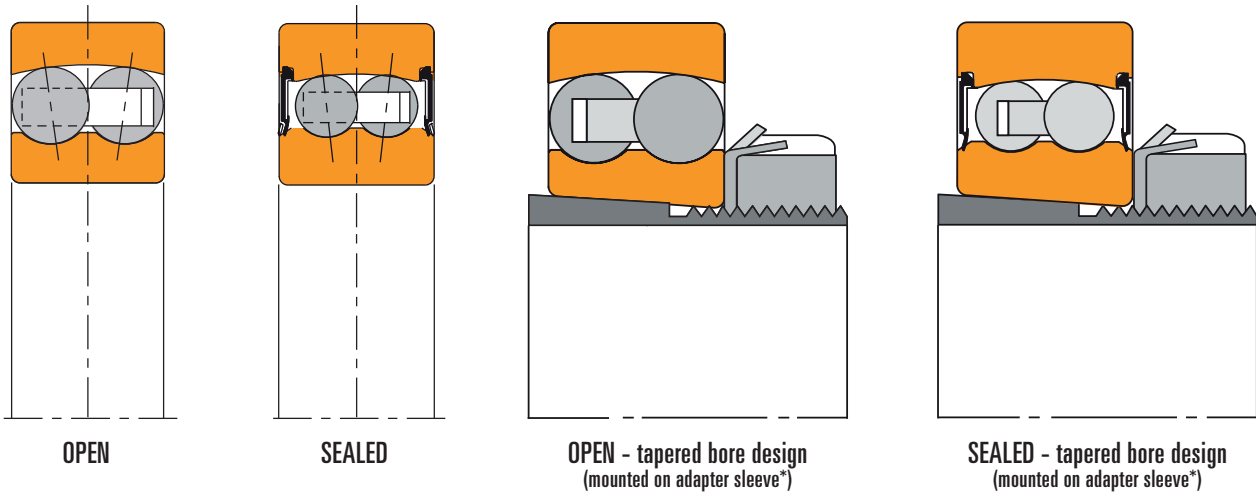

*Adapter sleeves must be ordered separately. Part numbers can be found in the Timken self-aligning ball bearing catalog.

NOMENCLATURE

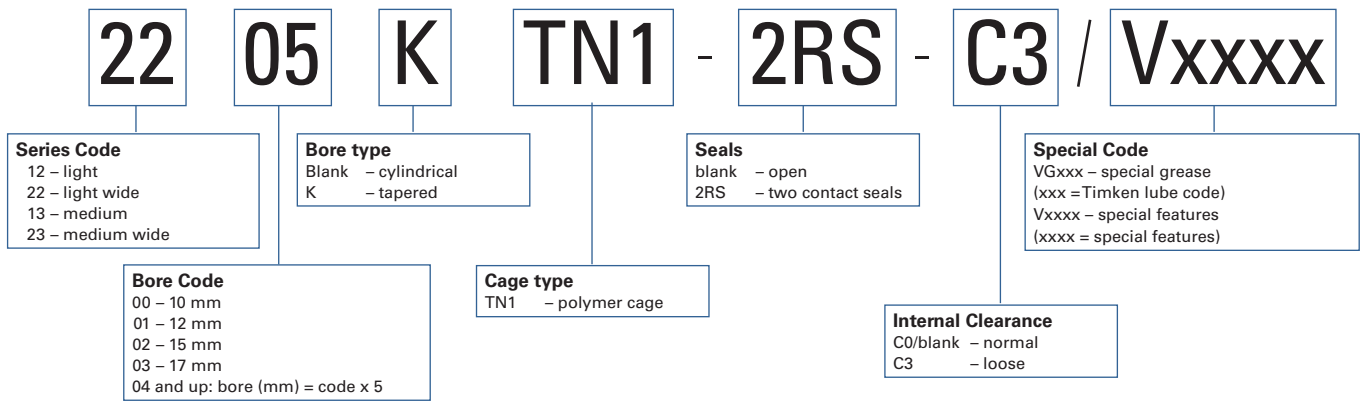

MISALIGNMENT TOLERANCES

Series	Misalignment*
Open bearing	
12, 22, 13 and 23	3°
Sealed bearing	
22-2RS and 23-2RS	1.5°

*permissible angular misalignment

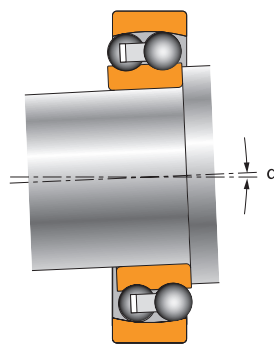

Mis-aligned Bearing



To view more catalogs, go to www.timken.com/catalogs for interactive versions, or to download a catalog app for your smart phone or mobile device scan the QR code or go to timkencatalogs.squawqr.com.

TIMKEN

The Timken team applies their know-how to improve the reliability and performance of machinery in diverse markets worldwide. The company designs, makes and markets bearings, gear drives, automated lubrication systems, belts, brakes, clutches, chain, couplings, linear motion products and related industrial motion rebuild and repair services.

Stronger. By Design.

www.timken.com