

TIMKEN® AP-2™ BEARING PARTS, LOAD AND LIFE DATA

TIMKEN

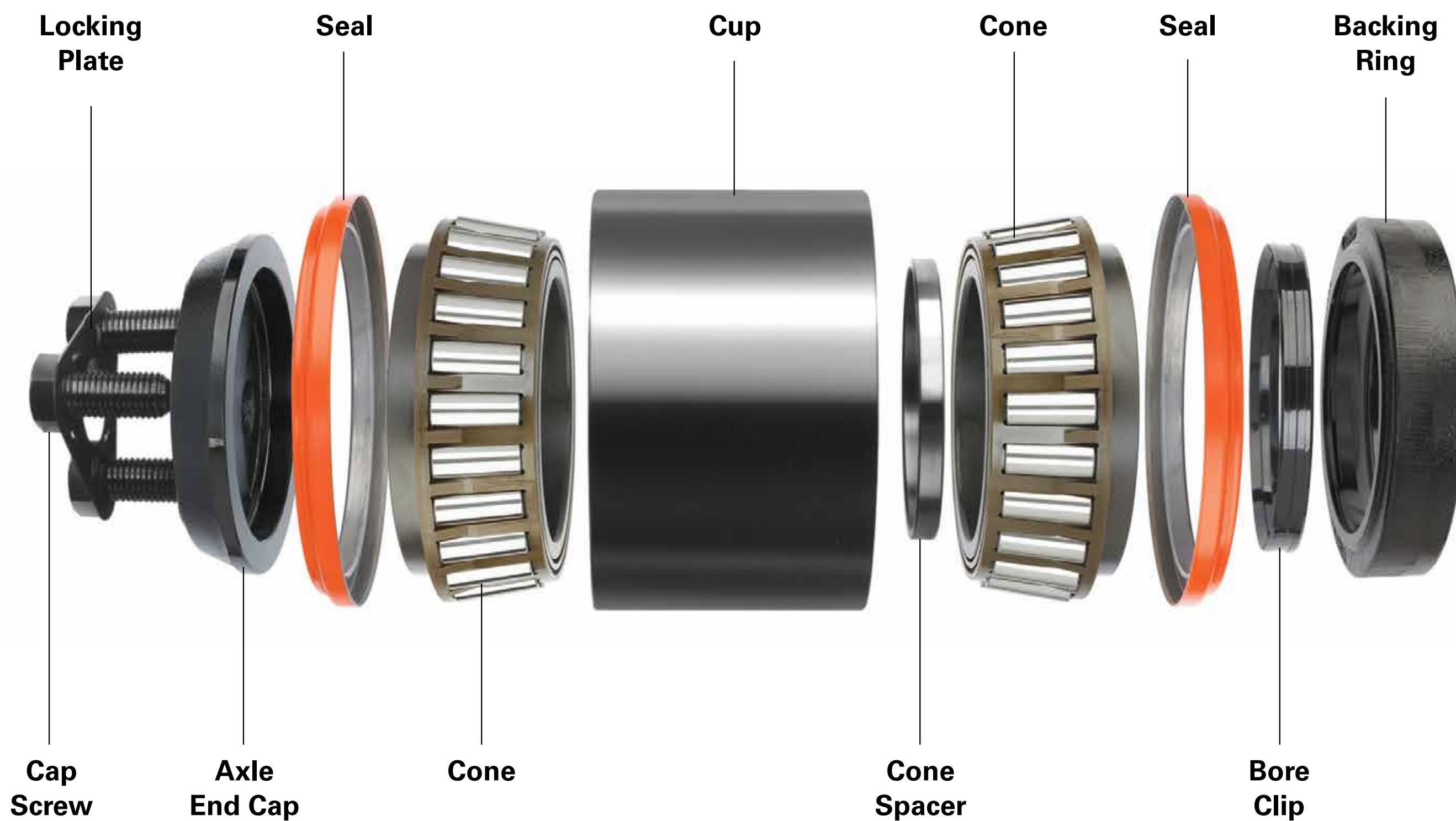

Class and Size	Bearing Rating at 500 RPM		Load Per Bearing Assembly	Percent Loading	L10 Life** Application Factor AF=1.0	
	Radial	Thrust			Full Load 100% of Time	Full Load 50% of Time
	lbs.	lbs.			miles	miles
L (6 X 8)	43,800	11,400	26,250	59.9	*811,400	*1,615,600
K (6 ½ X 9)	59,700	15,500	■ 34,375	57.6	+1,011,500	+2,015,300
M (7 X 9)	67,200	16,600	38,000	56.5	▲ 1,134,100	▲ 2,261,100

* 33-inch Diameter wheels, + 36-inch Diameter wheels, ▲ 38-inch Diameter wheels

** Multiplying factors – AF 1.5 = 0.26, AF 1.75 = 0.16, AF 2.0 = 0.10

■ 286,000 Pounds gross rail load

Class and Size	Car Capacity (Tons)	Bearing Assembly with Steel Cage	Cone Bore	Cup O.D.	Bearing Assembly with Polymer Cage
	tons		in.	in.	
L (6 X 8)	70	NP891226 90011	5.6870	8.6564	–
K (6 ½ X 9)	100	NP633994 90019	6.1870	9.8375	NP633994F 90019
M (7 X 9)	125	NP239427 90011	6.4995	10.3750	–

The Timken team applies their know-how to improve the reliability and performance of machinery in diverse markets worldwide. The company designs, makes and markets bearings, gear drives, automated lubrication systems, belts, brakes, clutches, chain, couplings, linear motion products and related industrial motion rebuild and repair services.

Stronger. By Design.

www.timken.com